

May 30 - June 3, 1988
MITO
JAPAN

**FOURTH ANNOUNCEMENT
(FINAL)**

**INTERNATIONAL CONFERENCE
ON
NUCLEAR DATA FOR SCIENCE AND TECHNOLOGY**

1 Conference Information

The International Conference on Nuclear Data for Science and Technology will be held in Mito, Japan, on May 30 - June 3, 1988. Previous announcements have included the Conference aim, topics, location and activities. Procedures for submitting papers and information on hotel and registration have been provided. This Fourth announcement contains a preliminary program and the schedule for the Conference.

2 Registration

Registration starts at 4:00 p.m. on Sunday, May 29 in the lobby of the Mito Plaza Hotel; it will continue during the normal Conference hours for late arrivals from 8:00 a.m. to 6:00 p.m. at the registration desk. All participants are requested to register at their earliest convenience after arriving at the Conference Hotel.

A sample of the receipt which registered participants will be either sent in advance or received at registration, is enclosed in this announcement. In order to shorten waiting time, those who have prepaid the registration fee are requested to bring the receipt to the registration desk. Those who will pay the fee at registration should come to the separate desk for payment. The Conference fee will cover the Conference bag, a book of abstract, a copy of the proceedings, the Conference reception and the technical tour. The fee for student participants will not include a copy of the proceedings. The Conference banquet and the companion tours will have separate registration fees of ¥4,000 and approximately ¥10,000, respectively.

The student participants may be asked to present their student identifications. We request that Conference name tags, which all participants and their companions will receive at registration, be worn during the Conference. The name tag will serve as the identification badge of participants and the ticket of admission to some of the Conference activities.

3 Program

Approximately 350 abstracts have been received by the Conference secretariat. Program Committee reviewed all contributions and selected 80 papers for oral presentations and 166 papers for poster presentations. Together with 35 invited papers, these comprise a preliminary program of 281 papers. A complete list of the preliminary program is enclosed.

We have two sessions for oral presentations in parallel, one in the room A (Zuiun) and the other in the room B (Ume). The allotted presentation time is 12 min. including discussions. Similarly invited talks will be 20 min., 30 min. or 40 min. including discussions in the room A (Zuiun). All oral contributors are requested to avoid projecting tables and graphs which are illegible for the audience. Please make materials to be read from a distance of 20 m.

Posters are expected to be displayed during the entire week of the Conference in the two poster rooms C (Tachibana) and D (Zuiun (East)). The location of the poster presentations will be indicated by attaching the paper numbers to the mounting boards. The posters must be placed on the boards by the contributors as early as possible.

4 Transportation

Most international flights arrive at the New Tokyo International Airport (Narita), about 66 km (41 miles) away from central Tokyo. The most recommended way to reach Mito is to take a Keisei Line's connecting bus, which departs from the arrival lobbies, to Keisei Narita Airport Station, and then a limited express train "Skyliner" to Keisei Ueno Station in downtown Tokyo in one hour. Participants are then requested to change to JR Joban limited express train "Hitachi" for Mito at JR Ueno Station with a few minute walk.

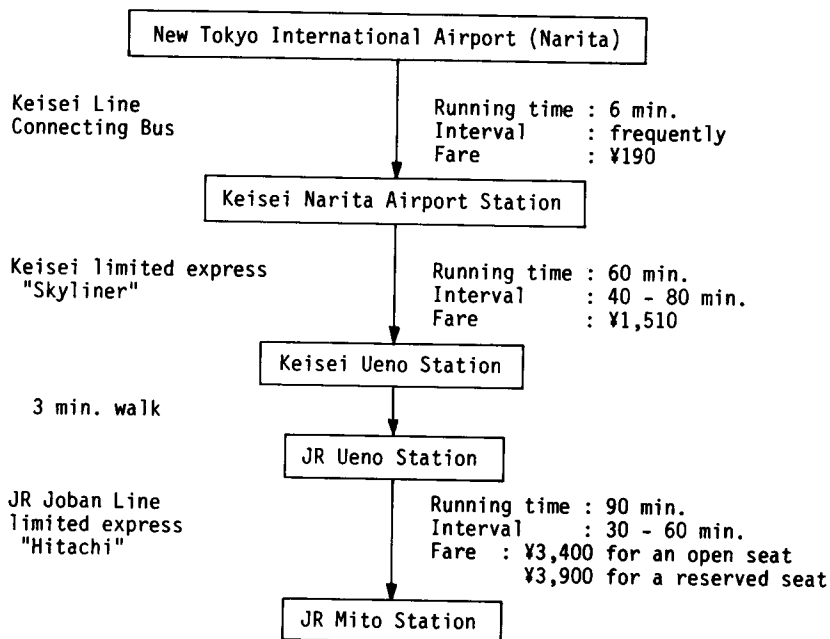

If you take a taxi from the airport to Mito, fare will be approximately ¥20,000 (time required: 2.5 hours). All information given above is current as of January, 1988. For further details, please consult your travel agent or carrier.

5 Proceedings

All authors are requested to bring or mail their final manuscripts to the Conference secretariat by not later than May 30, 1988 (at the beginning of the Conference). The manuscript will be used directly for offset printing by a publisher and therefore must be prepared in a "camera-ready" form. All papers must be typed on the special forms supplied to each author and must follow the instructions that were provided. The maximum length of contributed papers is 4 pages; the maximum length of invited paper is 8 pages. In addition to the camera-ready paper, each author is asked to provide one clear copy to the registration desk and bring at least 10 extra copies for the interested persons.

To publish the Proceedings, we require that the enclosed form for transfer of copyright agreement be signed by at least one author of each

paper. If you can not attend the Conference, please provide your signed forms with your camera-ready manuscript, either by mail or transported by someone who is attending the Conference. All copyright agreements must be received by the end of the Conference. The authors are responsible to obtain the necessary approvals and/or clearances from their own institutions.

Reprints of contributed papers given at the Conference can be requested by filling out the Reprint Order Form at the registration. The publisher agreed to send 10 copies of the reprints without charge.

In addition to their own copies of the Proceedings which are included in the registration fee, participants can order extra copies with the discount price of ¥15,000 at the registration. The number of extra copies is limited to be about 100. Additional copies will be available from the publisher with a commercial price.

6 Reception and Banquet

All participants and their companions will be invited to the Conference reception on Monday evening, May 30, 7:30 - 9:30 p.m. at the Conference room A (Zuiun). The Conference banquet will be also held on Thursday evening, June 2, 7:30 - 9:30 p.m. at the same Conference room A (Zuiun).

7 Tours

Tours of either Japan Atomic Energy Research Institute (JAERI) or Tsukuba Science City are planned on Wednesday afternoon, June 1. Conference participants were asked to indicate a preference for one of the two tours by the pre-registration form. The buses for transportation will be prepared from the Entrance of the Conference Hotel at 2:00 p.m.

The tour of JAERI will include visits to the Tandem Accelerator, the Fusion Neutronics Source (FNS) facility and the Nuclear Safety Research Reactor (NSRR) in the Tokai Research Establishment and the Large TOKAMAK Device (JT-60) in the Naka Research Establishment.

The tour of Tsukuba Science City will include visits to the Large-Scale Earthquake Simulator in National Research Center for Disaster Prevention, high energy accelerator TRISTAN and Photon Factory in National Laboratory

for High Energy Physics.

8 Companion program

Approximately 30 people have expressed interest in the companion program. The guided tours of nearby scenic and historic places are planned in the afternoon on Monday, Tuesday and Thursday. They will include a visit to Kasama City which is famous for pottery, a sightseeing of the park and museum in Mito City and a tour of northern Ibaraki. Details will be included in the Conference bag. The companion program will have a separate registration fee of approximately ¥10,000.

9 Currency and Banking

Only Japanese Yen(¥) is acceptable at regular stores and restaurants. Certain foreign currencies and credit cards may be accepted at the limited number of hotels (as shown in the separate sheet), restaurants and souvenir shops.

There will be banking services available in the Conference Hotel on Monday and Thursday during the Conference. Although the bank will provide limited currency exchange services for major non-Japanese currencies, we recommend that foreign participants obtain sufficient Japanese currency or traveler's check in ¥ before arrival in Mito. The exchange rate fluctuates daily but the U.S. dollar equaled around ¥125 in February, 1988.

10 Visa and Visit Proposal

All foreign visitors desiring to enter Japan must have a valid passport. Visas are also required for participants from some countries except the following countries.

Argentina, Austria, Bahamas, Bangladesh, Barbados, Belgium, Brunei, Canada, Chile, Colombia, Costa Rica, Dominican Republic, El Salvador, Finland, Federal Republic of Germany, Greece, Guatemala, Honduras, Iceland, Iran, Ireland, Israel, Italy, Lesotho, Liechtenstein, Luxembourg, Malaysia, Malta, Mauritius, Mexico, Netherlands, New Zealand, Norway, Pakistan, Peru, Portugal, San Marino, Singapore, Spain, Surinam, Sweden, Switzerland, Tunisia, Turkey, United Kingdom, Uruguay, Yugoslavia

No special vaccinations are necessary unless visitor enters Japan from an infectious disease afflicted area, in which case he must possess a valid International Certificate of Vaccination. For details, please consult your travel agent or the nearest Japanese diplomatic mission.

It is also necessary that we receive a completed VISIT PROPOSAL FORM for you and your companion who are interested in visiting JAERI. Two forms are provided and enclosed in this announcement; one for those who will join the technical tour and another for those who wish to visit JAERI individually. Only persons who have completed and returned the form will be able to visit JAERI. Please fill up one form per person and send it to an embassy or other diplomatic mission of your country in Japan and also send its copy to the Conference secretariat by not later than April 15, 1988.

For any inquires, please contact:

Dr. Sin-iti Igarasi	Phone	: 0292-82-5480
Conference Secretariat	Telex	: J24596
Nuclear Data Center	Facsimile	: 0292-82-0528
Japan Atomic Energy Research Institute		
Tokai-mura, Naka-gun		
Ibaraki-ken, Japan		

Plan of the Conference Rooms

2F

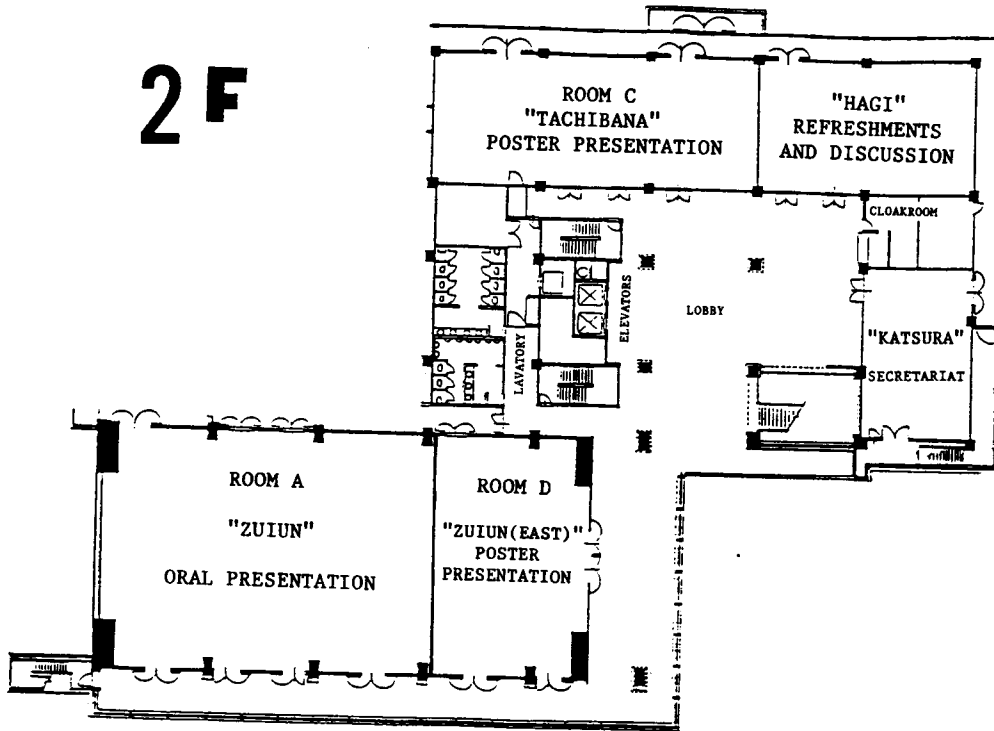

3F

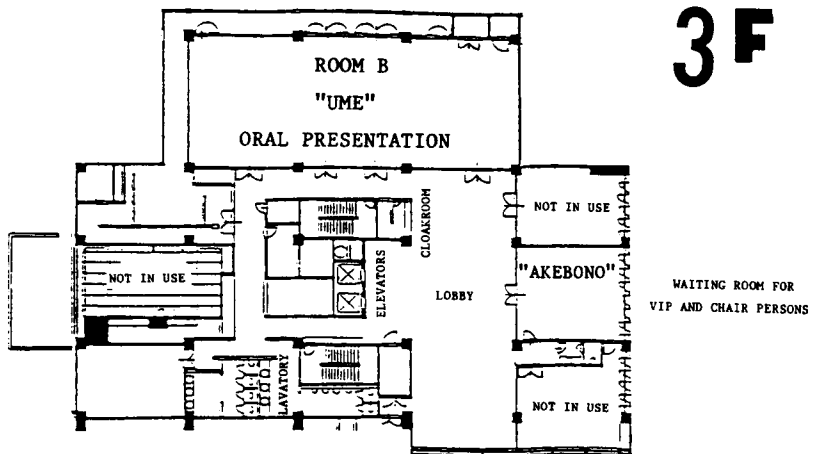

Tentative Time Schedule
International Conference on Nuclear Data for Science and Technology
Mito, Ibaraki, May 30 ~ June 3, 1988

	May 30 Monday	May 31 Tuesday	June 1 Wednesday	June 2 Thursday	June 3 Friday
8:30					
9:00	Opening and Keynote Talk (9:45)	Invited Talks for Topic H (IH) [2] IH01 - IH02 (9:25)	Topic A (AA) [5] AA05-AA09 ; Topic E (BE) [5] BE05-BE09 (9:40)	Invited Talks for Topic F (IF) [4] IF01 - IF04	Invited Talks for Topic G (IG) [4] IG01 - IG04
10:00		Invited Talks for Topic J (IJ) [3] IJ01 - IJ03 (10:30)	Topic I (AI) [4] AI01-AI04 ; Topic J (BJ) [4] BJ05-BJ08 (10:35)	(R) (10:40)	(R) (10:35)
11:00	(10:00) Invited Talks for Topic C (IC) [4] IC01 - IC04 (11:45)	Posters II (CC,CD,CG,DD) (R) (12:00)	(R) (11:00)	Topic C (AC) [6] AC05-AC10 ; Topic H (BH) [6] BH01-BH06 (12:00)	Topic A (AA) [5] AA10-AA14 ; Topic G (BG) [5] BG01-BG05 (11:45)
12:00	Special Talk (12:10)		Topic B (AB) [5] AB08-AB12 ; Topic D (BD) [5] BD01-BD05 (12:10)		
13:00	Lunch (13:40)	Lunch (13:30)	Lunch (13:40)	Lunch (13:30)	Lunch (13:30)
14:00	Invited Talks for Topic B (IB) [3] IB01 - IB03 (14:55)	Topic A (AA) [4] AA01-AA04 ; Topic J (BJ) [4] BJ01-BJ04 (14:25)	(14:00)	Invited Talks for Topic E (IE) [4] IE01 - IE04	Invited Talks for Topic A (IA) [4] IA01 - IA04 (15:10)
15:00	Posters I (CB,CH,CI,DJ) (R) (16:25)	Topic C (AC) [4] AC01-AC04 ; Topic E (BE) [4] BE01-BE04 (15:20)	Tour	(15:20)	
16:00		(R) (15:50)		Posters III (CA,CF,DE) (R) (16:50)	Closing (16:00)
17:00	Topic B (AB) [7] AB01-AB07 ; Topic F (BF) [7] BF01-BF07 (18:00)	Invited Talks for Topic D (ID) [5] ID01 - ID05 (18:00)		Invited Talks for Topic I (II) [2] II01 - II02 (18:00)	
18:00					
19:30	Reception			Banquet	

(R): Refreshment